 <p>पी डी आई एल PDIL</p>	<p>COOLING TOWER PACKAGE INCLUDING COOLING WATER TREATMENT SYSTEM ON PACKAGE BASIS</p> <p>TALCHER FERTILISERS LIMITED ODISHA (INDIA)</p>	 <p>Talcher Fertilizers</p>
--	--	--

Date: 01.07.2022

AMENDMENT – II

NIT, No. : PNMM/PC-183/E-4011/NCB Dated 20.05.2022

Sub.: COOLING TOWER PACKAGE INCLUDING COOLING WATER TREATMENT SYSTEM ON
PACKAGE BASIS AT TALCHER FERTILIZERS LIMITED, TALCHER, ODISHA

This is for information of Bidders that **Amendment-II** date **01.07.2022** is being issued and shall be read in conjunction with the original Tender document issued on 20.05.2022 and all its subsequent amendment.

For & on behalf of
Talcher Fertilizers Limited



P. R. Sahu
Addl. G.M (M.M)
Projects & Development India Ltd.



SUBJECT: COOLING TOWER PACKAGE INCLUDING COOLING WATER TREATMENT SYSTEM ON PACKAGE BASIS FOR TALCHER FERTILIZERS LIMITED, ODISHA
NIT No.: PNMM/PC-183/E/4011/NCB Dated 20.05.2022
AMENDMENT No.: II, Dated : 01.07.2022



Sl. No.	Reference of Bidding Document				Existing Clause as per NIT	Amendment Type	Amended Clause
	Part / Sec	Page No.	Clause no	Subject / Heading		M/D/A	
1.	Part VI	337 of 1506	1.5.1	Material of construction	ii) Hot water distribution pipes for counter flow tower from hot water duct of each cell: CS vi.) Louvers : RCC vii) Fills : FRP/PVC (Fire Resistant) xii) a) Sluice gate: Galvanized steel	M	ii) Hot water distribution pipes for counter flow tower from hot water duct of each cell: PVC as per IS 4985 vi.) Louvers : PVC/FRP vii) Fills : FRP/ Polypropylene/PVC (Fire Resistant) xii) Sluice gate: Galvanized steel/ Cast Iron
2.	Part VI	356 of 1506		Plot Plan	Drg.no.PC813-0000-0001 Rev.0	M	Drg.no.PC813-0000-0001 Rev.01_OP
3.	Part VI	575 of 1506	3.12	EOT Crane	3.12. EOT cranes LSTK / PACKAGE Contractor to provide EOT Cranes of adequate capacity in various Pump Houses, Compressor & turbine House and other location wherever required for ease in operation and maintenance activities . Cranes to be provided in nearest multiple of 5 Metric Tonnes considering maximum weight to be lifted. Relevant Indian/ ISO Standards to be applicable for EOT Crane. All statutory guidelines to be complied by the contractor/ sub-contractor.	D	Deleted.



SUBJECT: COOLING TOWER PACKAGE INCLUDING COOLING WATER TREATMENT SYSTEM ON PACKAGE BASIS FOR TALCHER FERTILIZERS LIMITED, ODISHA
NIT No.: PNMM/PC-183/E/4011/NCB Dated 20.05.2022
AMENDMENT No.: II, Dated : 01.07.2022



Sl. No.	Reference of Bidding Document				Existing Clause as per NIT	Amendment Type	Amended Clause
	Part / Sec	Page No.	Clause no	Subject / Heading		M/D/A	
4.	Part VI	967 of 1506	3.75	Control Philosophy	Bidder to submit separate 5 years Comprehensive AMC prices (with price break-up for each year) for all Control systems, analyzers. Bidder to provide breakup for each system (Control systems, O2 analyzers). It will NOT be a part of evaluation.	D	Deleted
5.	Part VI	330 of 1506	1.2(d)	Detailed scope of work	Reinforced cement concrete..... The basin including channel shall have a holding capacity to retain 10 minutes of re-circulating water between minimum water level and normal water level.	M	Reinforced cement concrete..... The basin including channel shall have a holding capacity to retain 5 minutes of re-circulating water between minimum water level and normal water level.
6.	Part VII	336 of 1506	1.3.2	Cooling Water Pumps	1.3.2 Cooling Water Pumps Nos. - 2W+1S Type - Horizontal Centrifugal Flow (Each) - 1700 m3/hr Discharge Pressure (Each) - 5.5 Kg/ cm2 (g) Design Pressure - 8 Kg/ cm2 (g)	A	1.3.2 Cooling Water Pumps Nos. - 2W+1S Type - Horizontal Centrifugal Flow (Each) - 1700 m3/hr Discharge Pressure (Each) - 5.5 Kg/ cm2 (g) Design Pressure - 8 Kg/ cm2 (g) MOC: Casing - CI impeller - SS316, shaft- SS410



SUBJECT: COOLING TOWER PACKAGE INCLUDING COOLING WATER TREATMENT SYSTEM ON PACKAGE BASIS FOR TALCHER FERTILIZERS LIMITED, ODISHA
NIT No.: PNMM/PC-183/E/4011/NCB Dated 20.05.2022
AMENDMENT No.: II, Dated : 01.07.2022



Sl. No.	Reference of Bidding Document				Existing Clause as per NIT	Amendment Type	Amended Clause
	Part / Sec	Page No.	Clause no	Subject / Heading		M/D/A	
							1.3.2.1 Pit Transfer Pump Nos. - 1W+1S Type - Horizontal Centrifugal Flow (Each) – by Bidder Discharge Pressure (Each) - 2.5 Kg/ cm2 (g) Design Pressure - 8 Kg/ cm2 (g) MOC: Casing - CI impeller - SS316, shaft- SS4140

M: MODIFICATION, A: ADDITION, D: DELETION

Note: - The clauses in Amendment shall take precedence/superseded over all other pre bid replies against the respective clause.

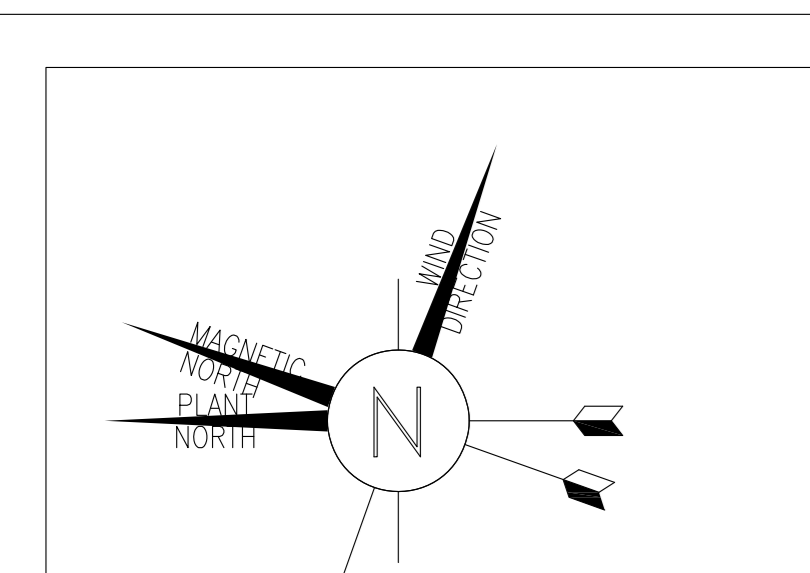
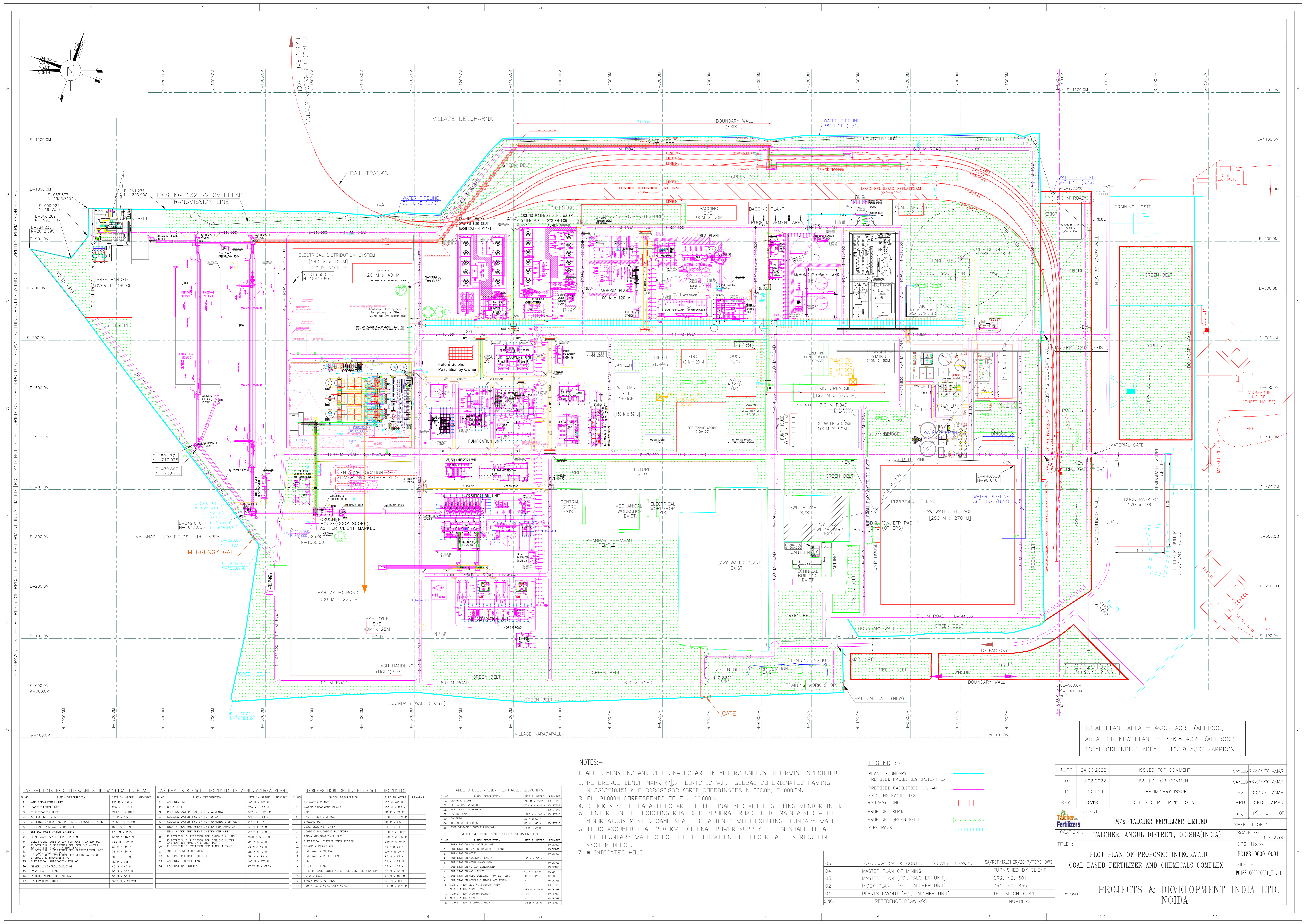

THIS DRAWING IS THE PROPERTY OF PROJECTS & DEVELOPMENT INDIA LIMITED (PDI) AND NOT TO BE COPIED OR REPRODUCED OR SHOWN TO THIRD PARTIES WITHOUT THE WRITTEN PERMISSION OF PDI.

TABLE-1 LSTK FACILITIES/UNITS OF GASIFICATION PLANT

S/NO	BLOCK DESCRIPTION	SIZE IN METRE	REMARKS
1	AIR SEPARATION UNIT	215 M x 101 M	
2	GASIFICATION UNIT	200 M x 115 M	
3	PURIFICATION UNIT	1337 M x 107 M	
4	SULFUR RECOVERY UNIT	78 M x 55 M	
5	COOLING WATER SYSTEM FOR GASIFICATION PLANT	985 M x 161.5M	
6	INITIAL RAIN WATER BASIN-1	21 M x 36 M	
7	INITIAL RAIN WATER BASIN-2	178 M x 233 M	
8	COAL WASH WATER PRE-TREATMENT	12.5M x 46.5 M	
9	ELECTRICAL SUBSTATION FOR GASIFICATION PLANT	715 M x 34 M	
10	ELECTRICAL SUBSTATION FOR COOLING WATER	27 M x 26 M	
11	ELECTRICAL SUBSTATION FOR PURIFICATION UNIT	40 M x 47 M	
12	STEAM GENERATION PLANT	31 M x 28 M	
13	GENERAL CONTROL BUILDING	40 M x 47 M	
14	GENERAL COAL STORAGE	90 M x 375 M	
15	PETCOKE/IMPURE STORAGE	90 M x 97 M	
16	LABORATORY BUILDING	30.5 M x 23.2M	

TABLE-2 LSTK FACILITIES/UNITS OF AMMONIA/UREA PLANT

S/NO	BLOCK DESCRIPTION	SIZE IN METRE	REMARKS
1	AMMONIA UNIT	100 M x 100 M	
2	UREA UNIT	156 M x 93 M	
3	COOLING WATER SYSTEM FOR AMMONIA	562.5 M x 105 M	
4	COOLING WATER SYSTEM FOR UREA	59 M x 140 M	
5	COOLING WATER SYSTEM FOR AMMONIA STORAGE	22 M x 27 M	
6	DELY WATER TREATMENT SYSTEM FOR AMMONIA	30 M x 24 M	
7	DELY WATER TREATMENT SYSTEM FOR UREA	29 M x 17 M	
8	ELECTRICAL SUBSTATION FOR AMMONIA & UREA	96.5 M x 28 M	
9	DELY WATER TREATMENT SYSTEM FOR UREA	24 M x 31 M	
10	ELECTRICAL SUBSTATION FOR AMMONIA TANK	40 M x 47 M	
11	DELY WATER TREATMENT SYSTEM FOR UREA	22 M x 17 M	
12	DELY WATER TREATMENT SYSTEM FOR UREA	22 M x 17 M	
13	GENERAL CONTROL BUILDING	58 M x 38 M	
14	LABORATORY BUILDING	20.75 M x 23.6M	

TABLE-3 DSBL (PDI/TL) FACILITIES/UNITS

S/NO	BLOCK DESCRIPTION	SIZE IN METRE	REMARKS
1	DM WATER PLANT	170 M x 40 M	
2	WATER TREATMENT PLANT	190 M x 93 M	
3	ETP	193 M x 70 M	EXISTING
4	RAW WATER STORAGE	200 M x 270 M	
5	BAGGING PLANT	100 M x 26 M	
6	DESK COILING TOWER	30 M x 30 M	
7	LOADING UNLOADING PLATFORM	600 M x 20 M	
8	STEAM GENERATION PLANT	200 M x 240 M	
9	ELECTRICAL DISTRIBUTION SYSTEM	240 M x 70 M	
10	DM AIR PLANT AIR	40 M x 20 M	
11	FIRE WATER STORAGE	100 M x 50 M	
12	FIRE WATER PUMP HOUSE	65 M x 15 M	
13	ETP	193 M x 70 M	EXISTING
14	DESK COILING TOWER	30 M x 30 M	
15	FIRE BRIGADE BUILDING & FIRE CONTROL STATION	25 M x 60 M	
16	FUTURE SILO	40 M x 100 M	
17	TRUCK PARKING AREA	170 M x 100 M	
18	ASH / SLAG POND (ASH POND)	300 M x 225 M	

TABLE-4 DSBL (PDI/TL) SUBSTATION

S/NO	BLOCK DESCRIPTION	SIZE IN METRE	REMARKS
1	SUB-STATION DM WATER PLANT	-	PACKAGE
2	SUB-STATION WATER TREATMENT PLANT	-	PACKAGE
3	SUB-STATION ETP	-	EXISTING
4	SUB-STATION BAGGING PLANT	-	PACKAGE
5	SUB-STATION COIL HANDLING	-	PACKAGE
6	SUB-STATION STEAM GENERATION	-	PACKAGE
7	SUB-STATION ASH DYKE	-	PACKAGE
8	SUB-STATION COIL BUILDING - PANEL ROOM	-	PACKAGE
9	SUB-STATION COILING TOWER	-	PACKAGE
10	SUB-STATION 110KV SWITCH YARD	-	EXISTING
11	SUB-STATION WAREHOUSE	-	PACKAGE
12	SUB-STATION ASH HANDLING	-	PACKAGE
13	SUB-STATION QUAYS	-	PACKAGE
14	SUB-STATION COILING ROOM	-	PACKAGE

- NOTES:-**
- ALL DIMENSIONS AND COORDINATES ARE IN METERS UNLESS OTHERWISE SPECIFIED.
 - REFERENCE BENCH MARK (⊕) POINTS IS W.R.T GLOBAL CO-ORDINATES HAVING N-2312910.151 & E-308680.833 (GRID COORDINATES N=000.0M, E=000.0M)
 - EL. 91.000M CORRESPONDS TO EL. 100.000M.
 - BLOCK SIZE OF FACILITIES ARE TO BE FINALIZED AFTER GETTING VENDOR INFO.
 - CENTER LINE OF EXISTING ROAD & PERIPHERAL ROAD TO BE MAINTAINED WITH MINOR ADJUSTMENT & SAME SHALL BE ALIGNED WITH EXISTING BOUNDARY WALL.
 - IT IS ASSUMED THAT 220 KV EXTERNAL POWER SUPPLY TIE-IN SHALL BE AT THE BOUNDARY WALL CLOSE TO THE LOCATION OF ELECTRICAL DISTRIBUTION SYSTEM BLOCK.
 - * INDICATES HOLD.

LEGEND :-

PLANT BOUNDARY	---
PROPOSED FACILITIES (PBI/TL)	---
PROPOSED FACILITIES (WUHAN)	---
EXISTING FACILITIES	---
RAILWAY LINE	---
PROPOSED ROAD	---
PROPOSED GREEN BELT	---
PIPE RACK	---

TOTAL PLANT AREA = 490.7 ACRE (APPROX.)
 AREA FOR NEW PLANT = 326.8 ACRE (APPROX.)
 TOTAL GREENBELT AREA = 163.9 ACRE (APPROX.)

REV.	DATE	DESCRIPTION	PPD.	CHK.	APPD.
1_OP	24.06.2022	ISSUED FOR COMMENT	SAYED	RKV/NSY	AMAR
0	15.02.2022	ISSUED FOR COMMENT	SAYED	RKV/NSY	AMAR
P	19.01.21	PRELIMINARY ISSUE	AM	DD/NS	AMAR

CLIENT : M/s. TALCHER FERTILIZER LIMITED
 LOCATION : TALCHER, ANGUL DISTRICT, ODISHA(INDIA)
 TITLE : PLOT PLAN OF PROPOSED INTEGRATED COAL BASED FERTILIZER AND CHEMICALS COMPLEX
 SCALE :- 1 : 2200
 DRG. No. :- PC183-0000-0001
 FILE :- PC183-0000-0001_Rev 1

PROJECTS & DEVELOPMENT INDIA LTD. NOIDA

S.NO	REFERENCE DRAWINGS	NUMBERS
05.	TOPOGRAPHICAL & CONTOUR SURVEY DRAWING	SA/RCF/TALCHER/2017/TOPO-DWG
04.	MASTER PLAN OF MINING	FURNISHED BY CLIENT
03.	MASTER PLAN [FCI, TALCHER UNIT].	DRG. NO. 501
02.	INDEX PLAN [FCI, TALCHER UNIT].	DRG. NO. 635
01.	PLANTS LAYOUT [FCI, TALCHER UNIT].	TFU-M-GN-6341